

KÆLDERETAGE / THE CELLARS

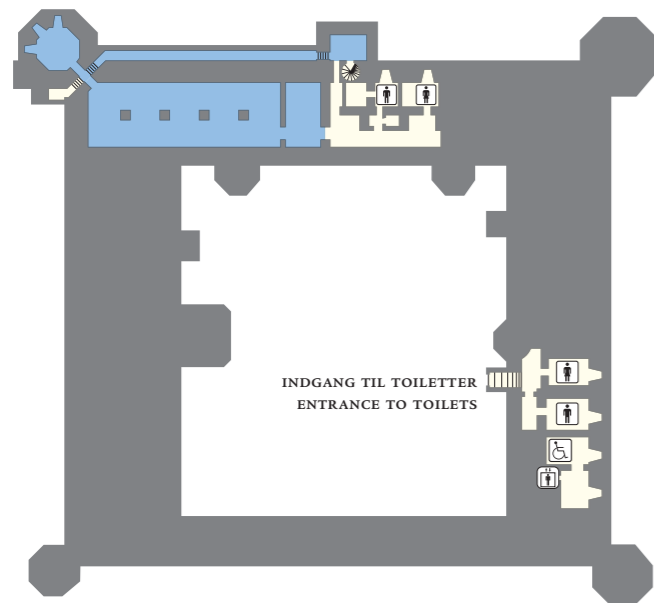

Kældrene

Vinkælder, vandkælder og møntkælder fra Christian IVs tid. Børnenes Danmarkshistorie i sommerhalvåret.

Cellars

Wine cellar, water cellar and mint cellar, dating from the time of Christian IV. Special exhibition for children during the summer.

Adgang for kørestole

Særlig indgang for kørestole fra slotsgården samt elevator og handicap-toiletter. Kørestole har adgang til alle etager, dog er kældrene, Slotskirken, Riddersalen og stue 84 ikke tilgængelige for kørestolsbrugere.

Access for wheelchairs

There is a special entrance for wheelchairs from the Courtyard, also an elevator and toilets for handicapped persons. Wheelchairs have access to all parts of the Castle except the cellars, the Chapel, the Great Hall and Room 84.

ADRESSE / ADDRESS: Frederiksborg Slot, DK-3400 Hillerød, Danmark
TELEFON / TELEPHONE: +45 48 26 04 39 · TELEFAX: +45 48 24 09 66
INTERNET: www.frederiksborgmuseet.dk

ÅBNINGSTIDER / OPENING HOURS:

April-oktober 10-17 alle dage / April-October 10 am-5 pm every day
Nov.-marts 11-15 alle dage / Nov.-March 11 am-3 pm every day

Produktion: F. Hendriksen Eff. · 03/2007 · Design: Mette & Eric Møller MDD



Det Nationalhistoriske Museum på Frederiksborg har siden 1878 haft til huse på slottet fra Christian IVs tid, som blev istandsat efter en brand i 1859. Museet er grundlagt af brygger J. C. Jacobsen som en særlig afdeling af Carlsbergfondet. Udover pragtrum som Slotskirken, Rosen, Audienssalen og Riddersalen rummer museet landets betydeligste samling af portrætter og historiemalerier samt fornem kunstindustri. Den kronologiske samling belyser Danmarks historie fra 1500 til i dag.

Denmark's Museum of National History has been housed at Frederiksborg Castle since 1878. The castle itself, which was built at the time of Christian IV (1588-1648), was restored after a fire in 1859. The Museum was founded by the brewer J. C. Jacobsen as a separate department of the Carlsberg Foundation. In addition to magnificent rooms such as the Chapel, the Rose, the Audience Chamber and the Great Hall, the Museum contains Denmark's most important collection of portraits and history paintings as well as distinguished examples of decorative art. The Chronological Collection illustrates Denmark's history from 1500 until the present day.



STUEETAGE / GROUND FLOOR

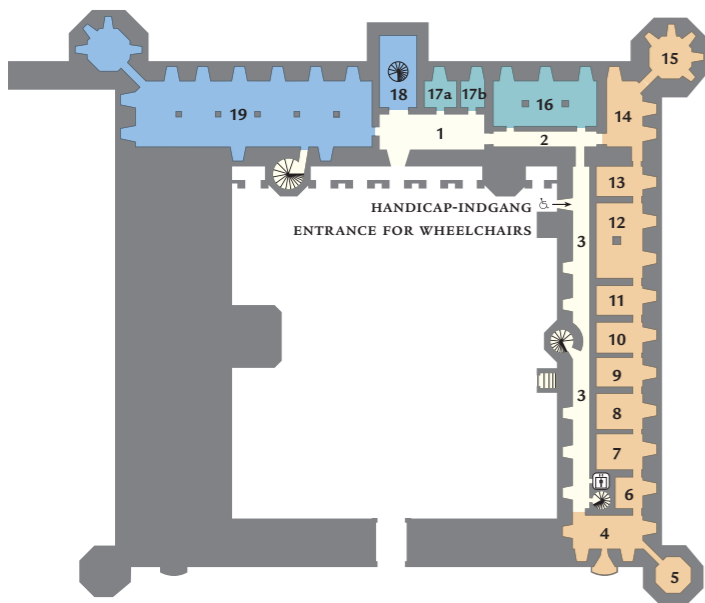

- 1500-1650
- 1650-1700
- 1700-1850
- 1850-1900
- 1900-



Slotskirken fra Christian IVs tid og Audienssalen, indrettet af arkitekten Lambert van Haven for Christian V i 1680erne. Tiden fra de første oldenborgske konger fra Christian I (1448-81) til Christian IV vises i stue 25-32. Perioden fra 1850-1900 med bl.a. de slesvigske krige ses i stue 61-68.

The Chapel, dating from the time of Christian IV, and the Audience Chamber, designed and completed by the architect Lambert van Haven for Christian V in the 1680s. The period of the first Oldenburg kings, from Christian I (1448-81) till Christian IV, is covered in Rooms 25-32. The period from 1850-1900, including the Slesvig Wars, is illustrated in Rooms 61-68.

- 17a GARDEROBE / CLOAKROOM
- 17b BILLETSALG / TICKETS
- 16 BUTIK / SHOP
- SÆRUDSTILLINGER / TEMPORARY EXHIBITIONS
- ELEVATOR



Rosen, eller Ridderstuen, stue 19. Rummet er genskabt som på Christian IVs tid (1588-1648), hvor det var spisesal for hoffets damer og kavalere. I de øvrige rum er der skiftende særudstillinger.

The Rose, Room 19, also called the Knight's Room, is a reconstruction of how it looked at the time of Christian IV, when it was used as a dining-room for the lords and ladies of the court. Various special exhibitions are held in the other rooms.

I museets butik fås illustrerede guider, kataloger, bøger, postkort, gaveartikler m.m. Kaffeautomat.

Museum Shop. Illustrated guides, catalogues, books, post-cards and souvenirs. There is also a coffee-machine.

I. SAL / 1st FLOOR

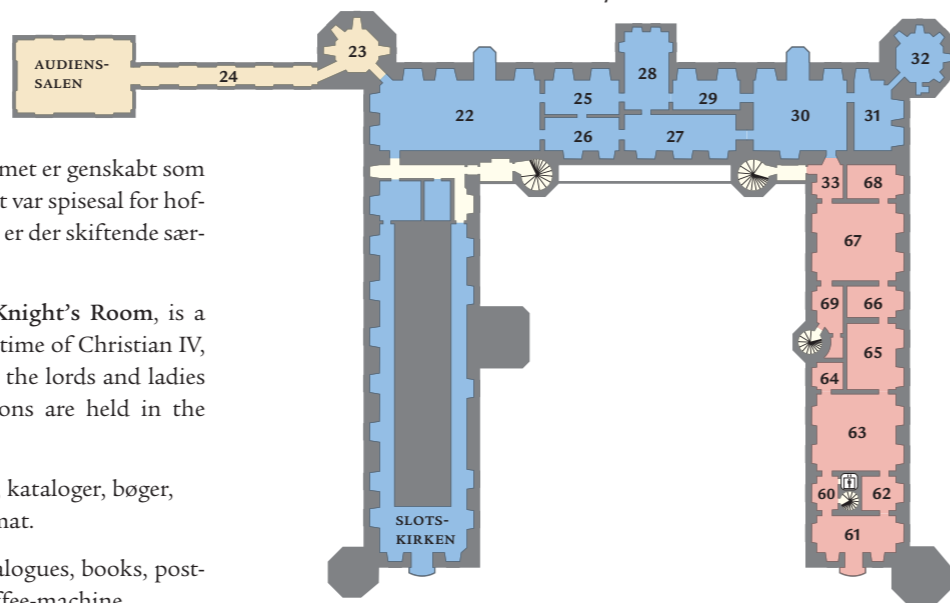

2. SAL / 2nd FLOOR

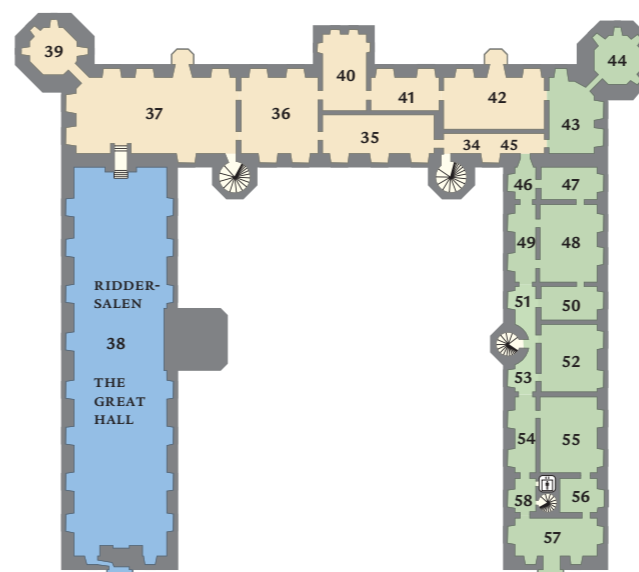

Riddersalen, stue 38, genskabt som på Christian IVs tid. Malerier, møbler og genstande, der viser den tidlige enevældes pompøse pragt, ses i stue 37-42. Portrætter og inventar fra 1700-1850 vises i stue 43-57.

The Great Hall, Room 38, reconstructed as it would have appeared in the time of Christian IV. Paintings, furniture and objects showing the pompous magnificence of the early period of absolutism can be seen in Rooms 37-42. Portraits and furnishings from 1700-1850 are shown in Rooms 43-57.



3. SAL / 3rd FLOOR

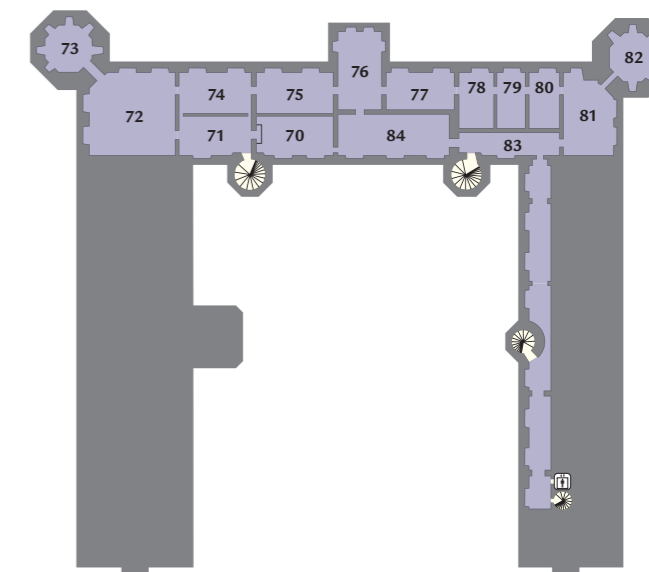

Moderne Samling

Danmark i det 20. og 21. århundrede skildret kronologisk og tematisk i portrætter og enkelte historiemalerier. Skiftende op-hængninger af moderne portrætfotografi. Biograf og videorum.



Modern Collection

Danmark in the 20th and 21st centuries, illustrated chronologically and thematically by portraits and a few history paintings. Alternating hangings of modern portrait photography. Cinema and video room.